

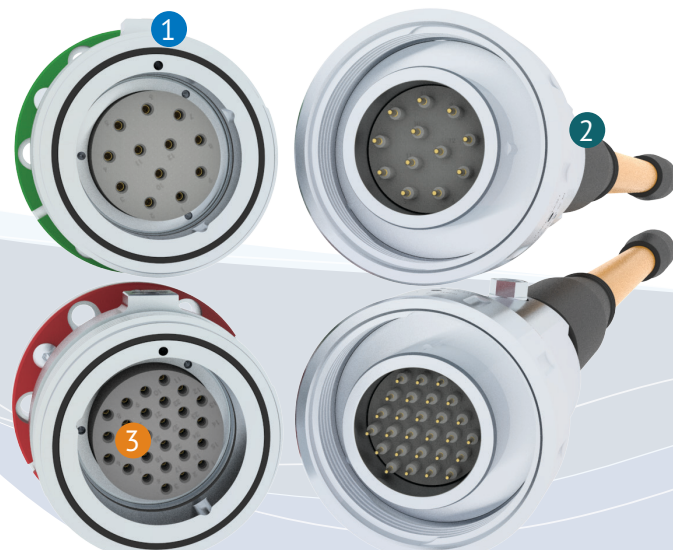

# Triton<sup>®</sup> Dry-Mate Connector

## Developed for Drilling & Controls Applications – ODI API 16D Dry-Mate Connector Series

The Triton<sup>®</sup> Series ODI API 16D Dry-Mate Connectors are hand-mateable and designed for submersible electrical connection systems with a requirement for API 16D:2018 compliance, where sealing barriers allow for testing after installation. Each connector set is comprised of one cable-end connector plug (CCP) with pressure-balanced oil-filled (PBOF) hose and one flange connector receptacle (FCR) with test port. All designs feature the use of robust, high-reliability materials. The overmolded electrical modules utilize engineering-grade plastics instead of the traditional GRE materials to provide product reliability in excess of current industry standards. Dual-barrier sealing is standard, and the rear of the CCP connector is specifically designed with the same qualified PBOF hose and terminations used in Teledyne ROV-mateable products to withstand wave battling and conditions of repeated deployments. Current configurations include 12-Way and 27-Way versions. Each are manufactured in similar packages but feature unique keying systems preventing mismatched pairs from mating. Other configurations are available upon request.



12-Way and 27-Way Triton<sup>®</sup>  
Dry-Mate Connector

- ① API 16D: 2018 Compliant test port /  
Approx 3.0" [7.62 cm]
- ② PBOF interface for CCP
- ③ Utilizes engineering-grade plastics instead of  
traditional GRE material

### PRODUCT FEATURES

- PBOF integration
- API 16D: 2018 compliant test ports
- Utilizes engineering-grade plastics instead  
of traditional GRE material
- Unique keying and color combinations  
available upon request



**TELEDYNE MARINE**  
Everywhere you look<sup>™</sup>

# Triton<sup>®</sup> Dry-Mate Connector

Developed for Drilling & Controls Applications

## TECHNICAL SPECIFICATIONS

### GENERAL SPECIFICATIONS

Operational Water Depth	15,000 ft
Operational Pressure (Incl. Test Port)	6,675 psi (460.2 Bar / 15,000 ft. depth equivalent)
Test Pressure	10,000 psi (689.5 Bar / 23,000 ft. depth equivalent)
Operational Temperature	-13 °F to 122 °F (-25 °C to 50 °C) seawater -20 °F to 122 °F (-29 °C to 50 °C) air
Storage Temperature	-22 °F to 140 °F (-30 °C to 60 °C)
Design Life	25 years - FCR Bulkhead 25 years - CCP PBOF Jumper
Mechanical Interface	Dry-Mate (Hand-mateable)
Mate/De-Mate Cycles	100
Rated Voltage	250 VAC (Phase to Ground) 440 VAC (Phase to Phase) 600 VDC
Rated Current (14 AWG Conductors. 20 AWG Conductors)	10A, 2.5A
Max Allowable Conductor Size (12-way)	14 AWG
Max Allowable Conductor Size (27-way)	20 AWG
Contact Resistance	≤ 0.03 Ω per physical contact
Insulation Resistance	≥ 10 GΩ @ 1,000 VDC
Guiding Specification	API 16D



**TELEDYNE MARINE**  
Everywhere you look™

[www.teledynemarine.com](http://www.teledynemarine.com)

1026 N. Williamson Boulevard, Daytona Beach, FL 32114 USA

Tel +1-386-255-0780 or 1-888-506-2326 Fax +1-386-255-0906

Email: [teledynemarine@teledyne.com](mailto:teledynemarine@teledyne.com)

网址 [www.aiboco.com](http://www.aiboco.com) 电话 029-88256270 邮箱 [sales@aiboco.com](mailto:sales@aiboco.com)

Specifications subject to change without notice.  
© 2020 Teledyne Marine. All rights reserved. DN 1418237 Rev C.